

# Installation Instructions

## Waunita Pass

Part # CMB029



**ID SCULPTURE**

PLAY. CLIMB. EXPLORE.

591 South Boulevard Street  
Gunnison, Colorado 81230  
info@idsculpture.com  
970-641-1747

### Specifications: Wuanita Pass Combo

- Material: GFRC Concrete with Structural Foam
- Approximate uninstalled size (SS Arch): 11'-7" x 6'-3" x 7'-3" Tall
- Approximate uninstalled size (SS Boulder): 6'-3" x 4'-8" x 6'-8" Tall
- Approximate uninstalled size (Timber!): 16'-6" x 7'-8" x 6'-4" Tall
- Approximate Weight (SS Arch): 6,300 Lbs
- Approximate Weight (SS Boulder): 2,800 Lbs
- Approximate Weight (Timber!): 8,000 Lbs
- Maximum fall height (SS Arch): 5'-10" (with 1' of safety surfacing)
- Maximum fall height (SS Boulder): 5'-8" (with 1' of safety surfacing)
- Maximum fall height (Timber!): 5'-0" (with 1' of safety surfacing)
- Age group: 5-12 years old

### Required Parts (included):

- Sandstone Arch GFRC sculpture
- Sandstone Boulder GFRC sculpture
- Timber! GFRC sculpture
- Parallel ropes and Hardware
- Hypar Net and Hardware
- 4"x4"x3/8" aluminum angle mounting brackets: 8ct
- Bolt Hanger (lifting eye): 14ct
- 3/4" X 8 1/2" SS Wedge Anchor: 8ct
- 1/2" X 8 1/2" SS Wedge Anchor: 2ct
- Igloo rope connector w/connection pin: 6ct
- Security Hex Key
- "Waunita Pass" drawing set

### Recommended Equipment (not included):

- Hammer Drill
- 3/4"x 10" concrete drill bit
- 1/2"x 10" concrete drill bit
- Air compressor
- Hammer
- 1-1/8" Wrench
- 3/4" Wrench
- 10' lifting straps: 4ct
- 8' lifting straps: 1ct
- Ratchet strap
- 12' Spreader Bar
- Large adjustable crescent wrench
- Wrench set / socket set
- 1/2" quick link: 6ct
- Shovels or skid steer with 16" auger
- Grinder with Cutoff Wheel or Hack Saw
- Lift: Reach Type Forklift 10,000lb Capacity or Crane

### Important Notes:

- *Warning: Installation over a hard surface such as asphalt, or packed earth may result in serious injury or death from falls.*
- *It is the responsibility of the installer to ensure all components are installed in compliance with ASTM F-1487.*
- *All site built footings should be allowed to cure for a minimum of 48 hours prior to installation.*

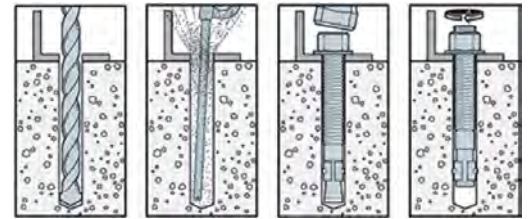

Typical Wedge Anchor Installation

# Installation Instructions

## Waunita Pass

Part # CMB029



591 South Boulevard Street  
Gunnison, Colorado 81230  
info@idsculpture.com  
970-641-1747

### PRE-INSTALL CHECKLIST

Please review prior to ordering and installing ID Sculpture products.

- ☐ 1. Verify that you have the recommended lifting equipment to unload and install your component, as specified by the installation instructions. Please check the installation instructions for the weight of each component and shipping dimensions.
- ☐ 2. Develop a proper plan to access the site and control access prior to opening.
- ☐ 3. Call your local utilities to locate any potential existing below grade equipment?
- ☐ 4. FOR ALL SCULPTURES: Verify you have accounted for adjustments to the footing depth based on your choice of safety surfacing material. Footing depth must be adjusted to compensate for the depth/thickness requirements of the selected safety surfacing (*see diagrams below*). Layout drawings show the uninstalled dimensions of the component. If you require a modification to a standard component, please notify ID Sculpture when placing your order. *Additional charges may apply.*

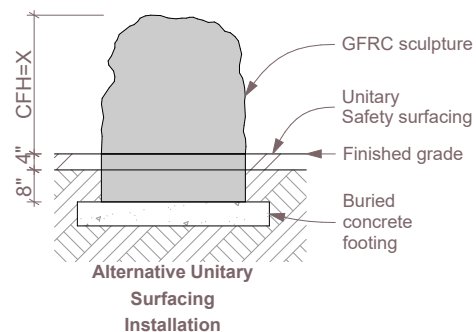
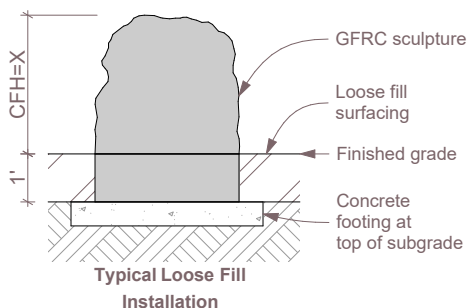

\*Critical Fall Height (CFH)

- ☐ 5. Verify that you have installed any required footings prior to the arrival of your sculptures. Please note, footings should be allowed to cure for a minimum of 7 days.

#### Important Safety Note:

Please install and maintain adequate protective surfacing under and around your equipment. Never let children play on the equipment before protective surfacing is installed. Please consult ASTM F1487 for more information.

# Installation Instructions

## Waunita Pass

Part # CMB029



591 South Boulevard Street  
Gunnison, Colorado 81230  
info@idsculpture.com  
970-641-1747

### Sculpture Installation: Sandstone Arch

1. Locate and construct the footer based on the provided layout plan drawing.
2. Make sure that the Bolt Hanger / lifting eyes (4ct) are securely attached to the bolts protruding from the base of the sculpture. Secure the (4) 10' lifting straps to Bolt Hangers using 1/2" quick links.
3. Lift the sculpture using an appropriate reach forklift or crane taking care to equalize the load on straps.
4. Set the sculpture in place and verify layout and all use zones as required by ASTM 1487.
5. Do not remove the bolt hangers or drill anchor holes until sculpture rope is installed and tensioned.

### Sculpture Installation: Sandstone Boulder

6. Locate and construct the footer based on the provided layout plan drawing.
7. Place the pallet mounted boulder on footing, disconnect the boulder to pallet connection bolts and discard.
8. Make sure that the bolt hanger / lifting eyes (4ct) are securely attached to the 5/8" bolts protruding from the base of the boulder. Secure the (4) 10' lifting straps to bolt hangers using 1/2" quick links.
9. Lift the sculpture using an appropriate reach forklift or crane taking care to equalize the load on straps.
10. Remove the pallet and set the piece in place on the footing.
11. Do not remove the bolt hangers or drill anchor holes until sculpture rope is installed and tensioned.

### Sculpture Installation: Timber!

12. Excavate the site 4" below the top of subgrade as per the provided layout drawings.
13. Compact the subgrade beneath the sculptures, level using sand as necessary.
14. Make sure that the bolt hanger / lifting eyes (6ct) are securely attached to the bolts protruding from the base of the sculpture. Secure the (4) 10' lifting straps and 8' lifting strap to bolt hangers using 1/2" quick links. (refer to pick diagram)
15. Lift the sculpture using an appropriate reach forklift or crane taking care to equalize the load on straps (this sculpture picks heavy on one end, take care to insure that it picks level by adjusting spreader bar pick point approximately 12" off center)
16. Set the sculpture in place according to layout.
17. Do not remove the bolt hangers until sculpture rope is installed and tensioned.

# Installation Instructions

## Waunita Pass

Part # CMB029



591 South Boulevard Street  
Gunnison, Colorado 81230  
info@idsculpture.com  
970-641-1747

### Sculpture Ropes Installation: Hypar Net

18. Connect sculpture ropes to GRFC sculptures with provided Igloo rope connectors & connection pins. (2)
19. Adjust rope tension between the two sculptures by carefully sliding one or both sculptures with crane or reach forklift before locating the chain connection points on the concrete piers.
20. Locate and mark the chain connection points on the piers by simultaneously pulling both chain lengths away from each other along the ground. Remove excess chain links as necessary.
- \*\*\* To avoid sagging in net, be sure to pull both chain lengths hard until net is raised to the proper height. \*\*\*
- \*\*\* Never install any rope component taut, some slack should always be present \*\*\*
21. Drill and clean holes with a 1/2" bit in the marked locations on the concrete piers to a minimum depth of 7 1/2".
22. Secure the supplied 1/2"x8-1/2" SS wedge anchors leaving 1-1/2" of thread exposed above footing.
23. Connect chain to the wedge anchor following the detail on page 5. Trim anchor stud flush with top of nut.
24. When proper tension is achieved verify all use zones as defined by ASTM 1487.

### Sculpture Ropes Installation: Over Under Ropes

25. Connect sculpture ropes to GRFC sculptures with provided Igloo rope connectors & connection pins. (4)
26. Adjust rope tension by carefully sliding one or both sculptures with crane or reach fork. (See image on page 5 for approximate proper tension)
27. When proper tension is achieved verify all use zones as defined by ASTM 1487.
- \*\*\* Never install any rope component taut, some slack should always be present. \*\*\*

### Sculpture Installation Continued:

28. Only after all sculpture ropes have been connected and adjusted and use zones as defined by ASTM 1487 have been verified, should the sculpture(s) be anchored to the ground.
29. Remove the bolt hangers on Sandstone Boulder, replace the 5/8" nut over mounting brackets.
30. Drill through the holes in the mounting brackets on SS Boulder with a 3/4" x 10" hammer drill bit to a minimum depth of 7 1/2", clean holes with compressed air and brush.
31. Install the 3/4"x8 1/2" stainless steel wedge anchors (4) and tighten.
32. Install resilient surfacing material in accordance with layout guidelines, and ASTM standards.

# Installation Instructions

## Waunita Pass

Part # CMB029



**ID SCULPTURE**

PLAY. CLIMB. EXPLORE.

591 South Boulevard Street  
Gunnison, Colorado 81230  
info@idsculpture.com  
970-641-1747



Typical Parallel Ropes Tension

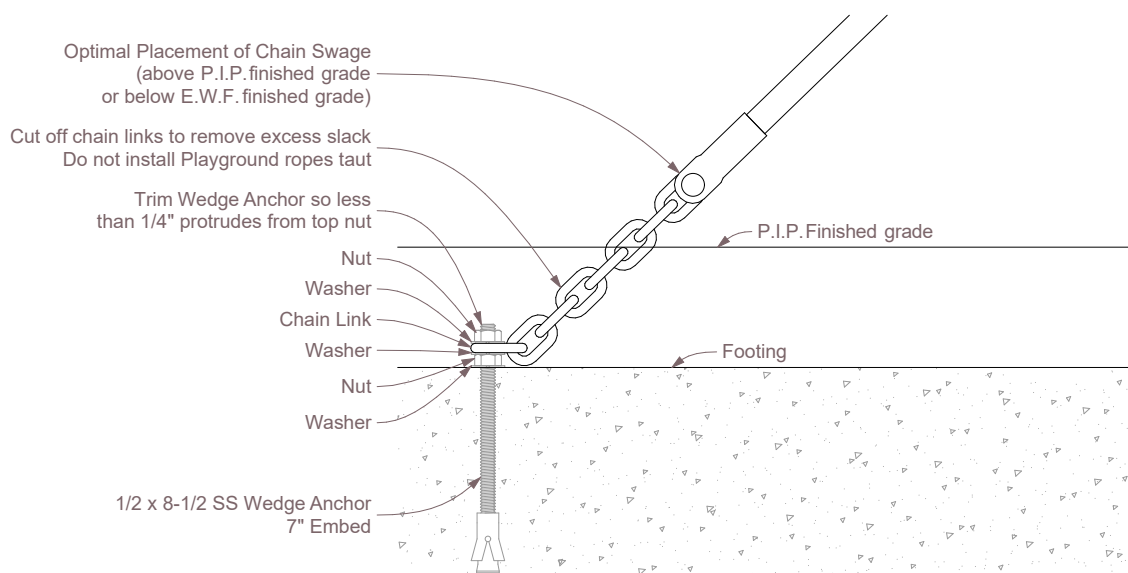

Rope to Footing Connection Detail



Female Threaded Connection



Installed Igloo Connector

# Installation Instructions

## Waunita Pass

Part # CMB029



**ID SCULPTURE**

PLAY. CLIMB. EXPLORE.

591 South Boulevard Street

Gunnison, Colorado 81230

info@idsculpture.com

970-641-1747

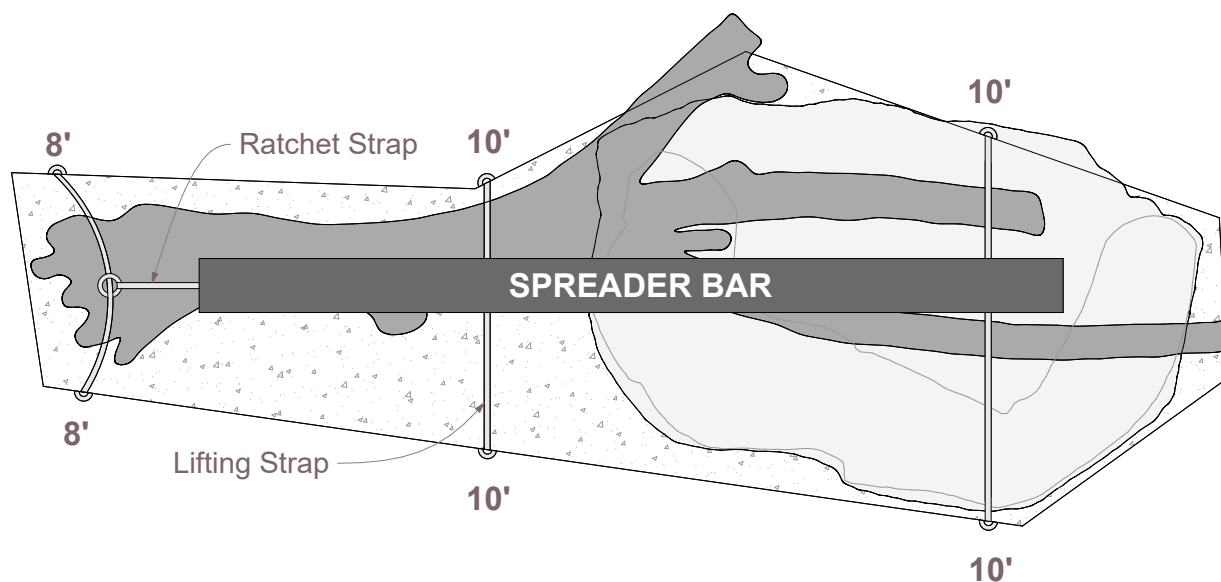

Timber! - Pick Diagram - Plan

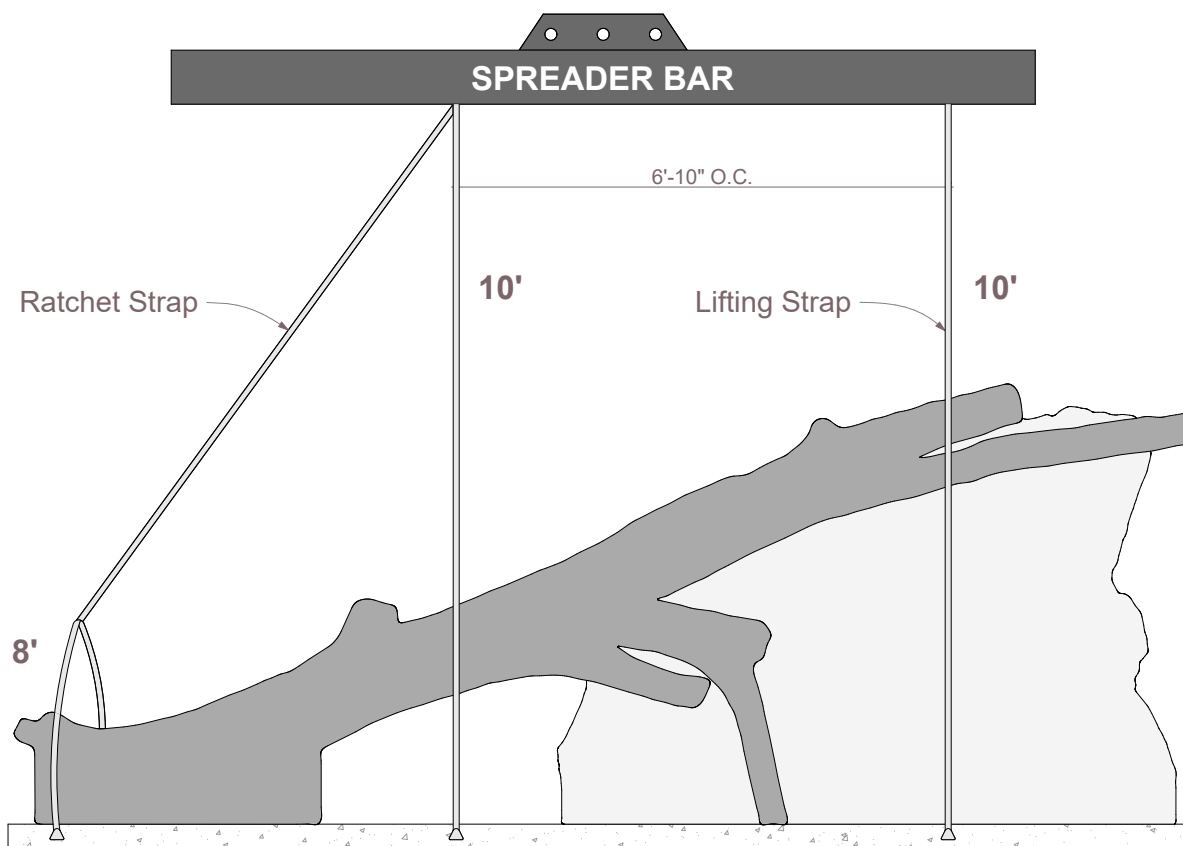

Timber! - Pick Diagram - Section



# Installation Instructions

## Waunita Pass

Part # CMB029



**ID SCULPTURE**

PLAY. CLIMB. EXPLORE.

591 South Boulevard Street  
Gunnison, Colorado 81230  
info@idsculpture.com  
970-641-1747

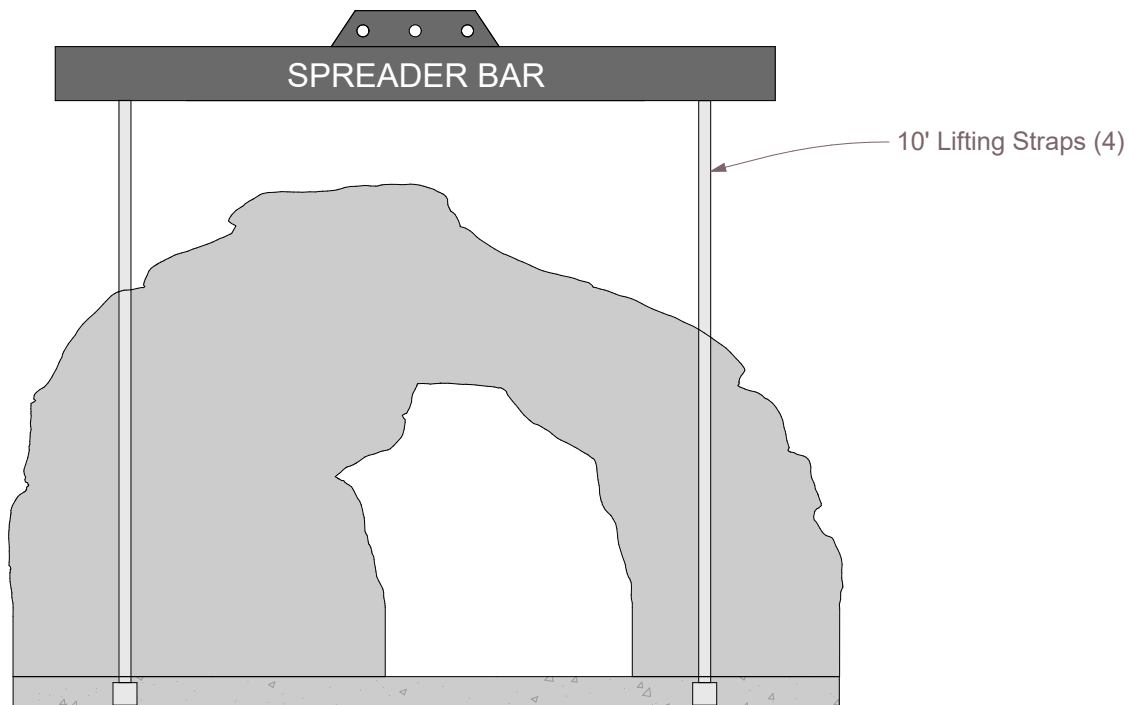

SS Arch - Pick Diagram - Elevation

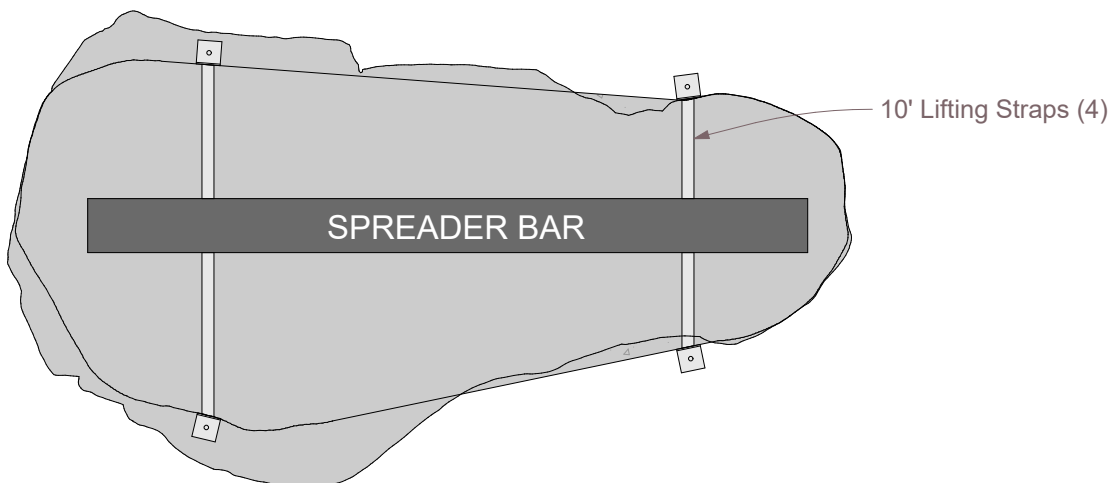

SS Arch - Pick Diagram - Plan

# Installation Instructions

## Waunita Pass

Part # CMB029



**ID SCULPTURE**

PLAY. CLIMB. EXPLORE.

591 South Boulevard Street  
Gunnison, Colorado 81230  
info@idsculpture.com  
970-641-1747

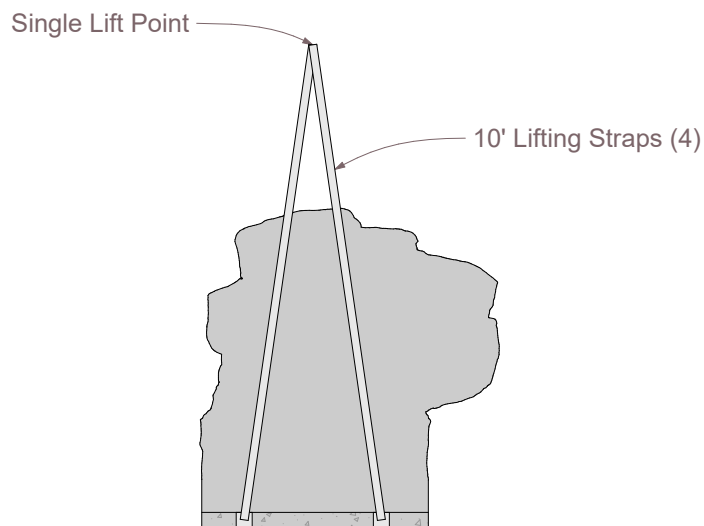

SS Boulder - Pick Diagram - Elevation

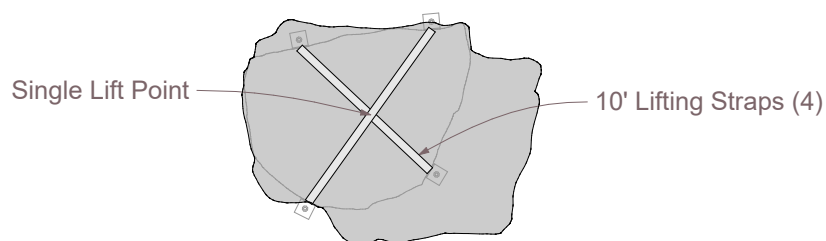

SS Boulder - Pick Diagram - Plan